

# REBUILD INSTRUCTIONS

## FLOATING HYDRAULIC RACE & EVO BEARINGS

### DISASSEMBLY:

1. Remove the spiral-lock retaineing ring, keeping it covered so that the spring does not fly out.
2. Remove the spring without scratching the piston.
3. Remove the piston, bearing and sleeve.
5. Remove lines and AN fittings.
6. Carefully remove the seals.

### INSPECTION:

1. Clean parts with soap and water and inspect all sealing surfaces for signs of wear and damage.
2. Replace damaged components.

### RE-ASSEMBLY:

1. Lubricate and install the new seals, taking care not to roll or over-stretch them.
2. Install the piston by hand, ensuring that it sits squarely, and press with a twisting motion.
3. Install the spring with the large diameter down.
4. Place the retaining washer onto the spring pushing it down enough to install the retaining ring.
5. Slowly release the load on the washer then install the bearing and sleeve assembly.
6. Attach AN fittings and lines, then bleed the release bearing.

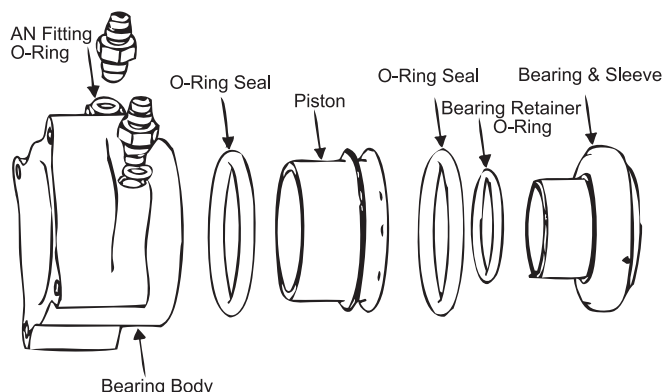

If you have any problems or concerns please contact our techs:  
(909) 877-6800, or [tech@clutchmasters.com](mailto:tech@clutchmasters.com).



# REBUILD INSTRUCTIONS

## TRI-LITE & UNIVERSAL RELEASE BEARINGS

### DISASSEMBLY:

1. Remove the piston and bearing assembly.
2. Remove the wiper seal.
3. Remove the AN-3 fittings and blow compressed air through the lines to remove the main seal.
5. Remove lines and other AN fittings.
6. Remove the fitting seals. (Tri-Lite Only)

### INSPECTION:

1. Clean parts with soap and water and inspect all sealing surfaces for signs of wear and damage.
2. Replace damaged components.

### RE-ASSEMBLY:

1. Lubricate the new main seal and fitting seals.
2. Install the main seal using the piston to ensure that the seal sits squarely.
3. Install the fitting seals (Tri-Lite Only) onto the AN fittings.
4. Attach AN fittings and lines.
5. Install the new wiper seal.
6. Carefully install the piston then bleed the release bearing.

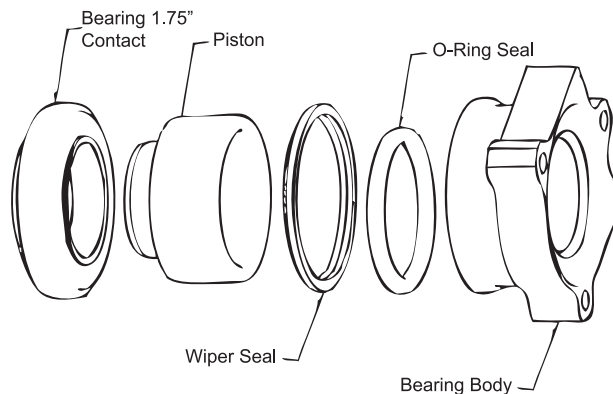

If you have any problems or concerns please contact our techs:  
(909) 877-6800, or [tech@clutchmasters.com](mailto:tech@clutchmasters.com).

